

CA0 Sperm Separation Device

User Manual For Professional use

Rev.30-0CA0000
20220819



Introduction

Please read this user manual carefully before using. LensHooke® CA0 Sperm Separation Device is designed, manufactured and authorized by Bonraybio Co., LTD. The device can effectively reduce debris from seminal plasma and select the sperm with higher motility, normal morphology, DNA integrity, and acrosome reaction to provide the further information for diagnosis. If you have any questions about the product or require any assistance, please feel free to contact Bonraybio by calling the Service Hotline (+886-4-24912385) or contact your local distributor. Service Hotline time : Mon~Fri 08:30~17:30 (GMT+8)

Intended use

LensHooke® CA0 Sperm Separation Device is for intrauterine insemination (IUI), in vitro fertilization (IVF), and intracytoplasmic sperm injection (ICSI) diagnosis and treatment. LensHooke® CA0 Sperm Separation Device adopts and improves the swim-up method to offer an easy-to-use device for assisted reproductive technology (ART) procedures. It is for in vitro diagnostic use only.

LensHooke® CA0 Sperm Separation Device Illustration / Device Component

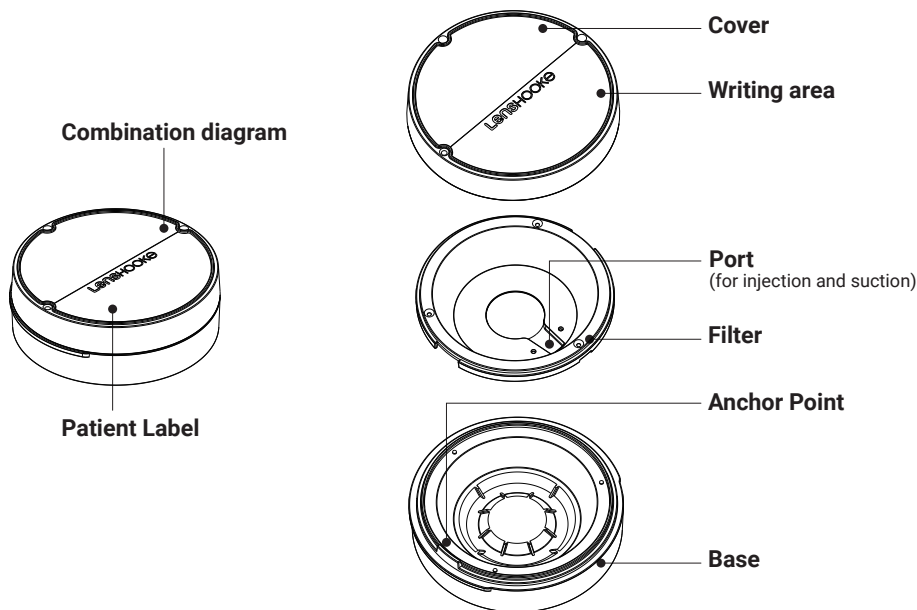

Principle

LensHooke® CA0 Sperm Separation Device is a sperm separation device which integrated with a filter film that applied swim-up method for assisted reproductive technology (ART).

Material and Equipment preparation (required but no provided)

- Sperm washing media (solution): commercial sperm washing medium, bicarbonate- or HEPES- buffered media supplemented with protein.
- 37°C incubator.
- 1mL Luer-Slip syringes, Pipetman and related accessories.
- Sperm-safe container.

Limitations

- LensHooke® CA0 Sperm Separation Device is designed ONLY for human sperm separation, please DO NOT use it for other kind of sample.
- DO NOT use under the operating temperature lower than 15°C (59°F) or higher than 38°C (100°F).
- If the incubation temperature below 37°C (98.6°F) and/or incubation time less than 30 minutes, the separation efficacy will decrease.

Product name	LensHooke® CA0 Sperm Separation Device
Size	Φ55.62 x H19.23 mm
Material	Polycarbonate, PC
Sterilization	Gamma irradiation sterilization
Operation Environment	15°C ~ 38°C (59°F ~ 100°F) , Humidity < 70%
Storage Environment	2°C ~ 30°C (36°F ~ 86°F)
Transportation Environment	-10°C ~ 60°C (14°F ~ 140°F) , Humidity < 70%

Reference

WHO laboratory manual for the Examination and processing of human semen.

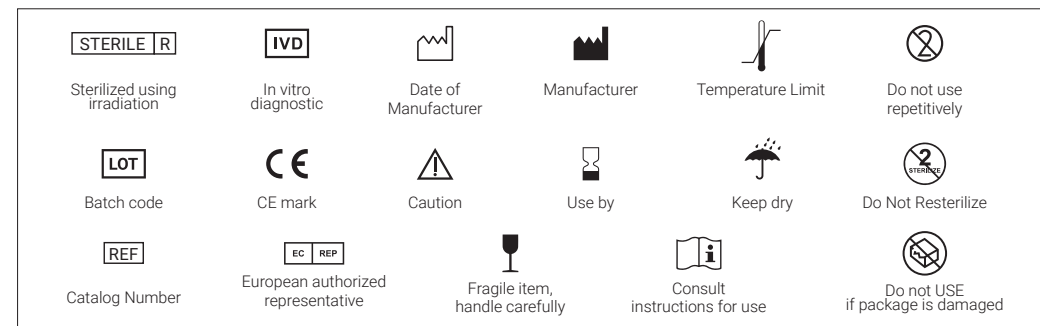

Manufacturer : Bonraybio Co., LTD.
Address : 4F., No.118, Gongye 9th Rd.,
 Dali Dist., Taichung City 41280, Taiwan
Tel : +886-4-2491-2385 **Fax :** +886-4-2491-2885
Email : support@bonraybio.com

EC REP
MDSS GmbH
 Schiffgraben 41
 30175 Hannover,
 Germany



LensHooke® CA0 Sperm Separation Device Operating Steps

Step 1. Wait 15~30 minutes for semen liquefaction.

Step 2. Well mix the sample.

Step 3. Open the package and remove the label of the device in the laminar airflow workbench.

Step 4. Take the cover as a holder and put the filter on it.

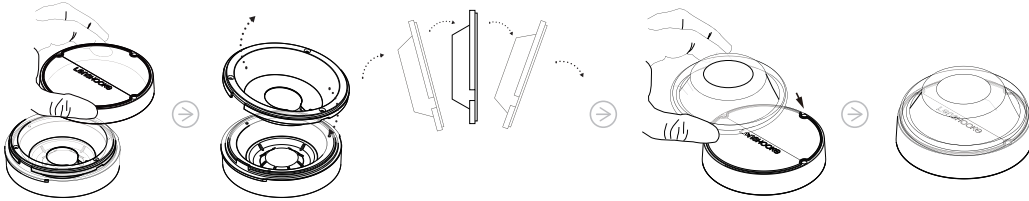

Step 5. Add 1 mL semen to the base and gradually fill the round cavity.

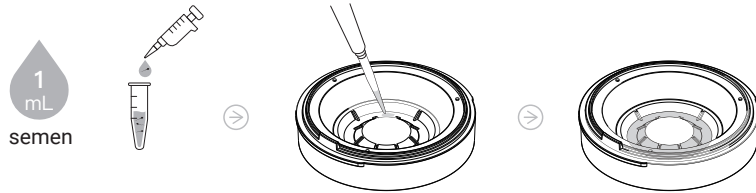

- If the semen volume does not reach 1 mL, you can add sperm washing medium to make up the volume before loading to the base.
- DO NOT add semen exceed 1 ml and should gradually add in the round cavity of base instead of the higher platform.

Step 6. Put the filter on the base carefully and make sure to fit in the anchor point.

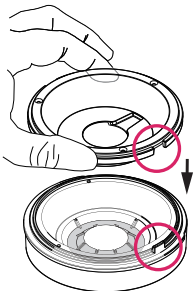

- There is an anchor point, you could choose a point to fit in first and then put the filter down slowly.
- Please slowly and gently put down the filter onto the base.

Step 7. Add 900 μ L of sperm washing medium through the port of the filter. Please move the pipette tips from the port to the membrane to fill in the rest medium when the liquid is full of the port area.



- Please DO NOT let the liquid exceed or be insufficient to the port area.
- When you add the medium to the filter, you should add it slowly and prevent making the bubble. The bubble will inhibit sperm to swim up.

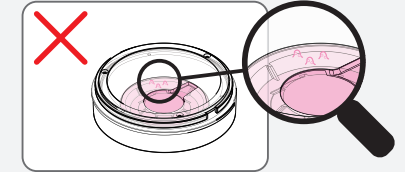

Step 8. Put the Cover on the filter and incubate the device at 37°C for 30 minutes.

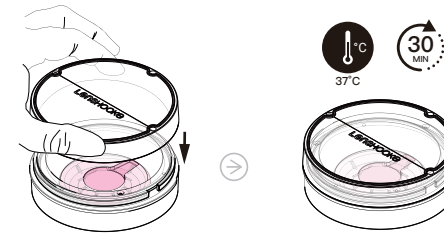

Step 9. Move the device from incubator to laminar airflow workbench, and take off the cover.



Step 10. Use pipette tips or syringes to SLOWLY suck 0.5 mL of the sperm containing fluid through the port.

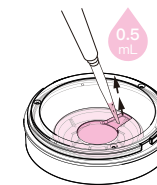

- DO NOT suck the sperm containing fluid too quickly to produce the bubble.

Step 11. Transfer the medium with selected sperm to an appropriate culture container for further application.

Cautions

- DO NOT reuse.
- DO NOT re-sterilize.
- DO NOT use if package is damaged.
- DO NOT use if the package is opened after 4 hours.
- DO NOT use if the membrane of filter is damaged.
- DO NOT use any sharp item to touch the membrane of the filter.
- DO NOT and vibrate the device during the separation procedure.